

panacom®

Audio Intercom Systems



- Easy to install and operate
- Offers security and convenience
- Crystal clear communication
- Expandable up to 1 master, 15 room and 2 door stations
- Compatible with Electrical Mounting Accessories

The Next Generation in Communication Technology

FEATURES

- **High quality speakers and microphone** offer crystal clear communication.
- **Monitor feature** allows for monitoring or listening in of children's room or nursery.
- **Paging feature** allows communication to all stations.
- **Mute feature** allows for privacy mode.
- **Hands free** reply from all units.
- **Volume** can be individually adjusted on each station.
- **Status Light.** Red and green LEDs indicate operational status and mode of system.
- **Door chime** to all stations when door station is activated.
- **Expandable** to 2 door stations with different door chime.
- **Horizontal or Vertical** mounting.

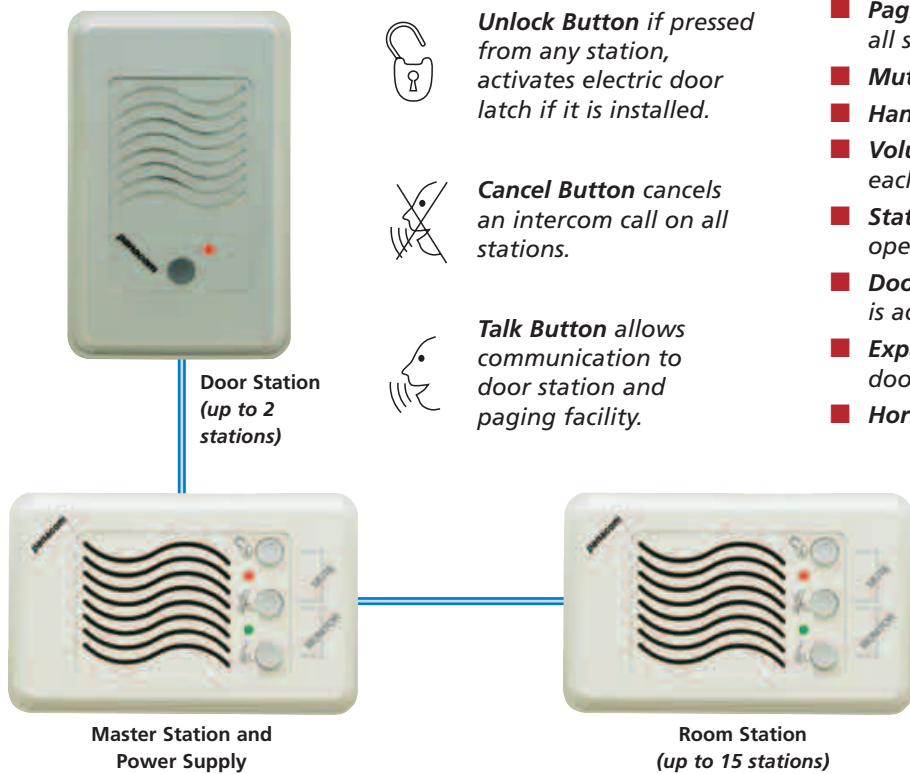

Unlock Button if pressed from any station, activates electric door latch if it is installed.



Cancel Button cancels an intercom call on all stations.



Talk Button allows communication to door station and paging facility.



ACCESSORIES



PAN-Q816DS
Silver Door Station



PAN-Q816DG
Gold Door Station



PAN-Q816S
White Room Station



PAN-800LR
Electric Door Latch (Recessed)



PAN-800LS
Electric Door Latch (Surface)



PAN-CPlate
Chrome Door Plate
(200H x 135W)



PAN-BPlate
Brass Door Plate
(200H x 135W)

Coloured Door Station Mounting Blocks (not shown)

PAN-MB816S (Silver Mounting Block)
PAN-MB816G (Gold Mounting Block)

SPECIFICATIONS

Power Supply:	16Vac 1.5A
System Cable:	3-pair twisted, shielded preferred
Max. total system cable length:	300m
System Capacity:	1 Master Room Station 2 Door Stations 15 Room Stations
Door Chime:	Electronic two-tone chime
Electric Door Latch:	12Vdc - 16Vdc 500mA max.
Physical Dimensions:	119(W) x 74(H) x 25(D) mm
Mounted Dimensions:	119(W) x 74(H) x 12(D) mm

MODEL Q816K START UP KIT

Start up kit with modular expansion contains:

- 1 x Master Station (Q816M)
- 1 x Power Supply (800A)
- 1 x Door Station (Q816D)

Another Quality Product by:



www.psaproducts.com.au



N10116

Due to our commitment to continuous improvement specifications may change without notice.

AVAILABLE FROM